

vtech[®]
baby

Instruction Manual

Play & Dream Kicking Piano



VTech understands that a child's needs and abilities change as they grow and with that in mind we develop our toys to teach and entertain at just the right level...

vtech Baby

Toys that will stimulate their interest in different textures, sounds and colours

I am...

...responding to colours, sounds and textures

...understanding cause and effect

...learning to touch, reach, grasp, sit-up, crawl and toddle

Birth-36 months



Pre-School

Interactive toys to develop their imagination and encourage language development

I want...

...to get ready for school by starting to learn the alphabet and counting

...my learning to be as fun, easy and exciting as can be

...to show my creativity with drawing and music so my whole brain develops

3-6 years



Electronic Learning Computers

Cool, aspirational and inspiring computers for curriculum related learning

I need...

...challenging activities that can keep pace with my growing mind

...intelligent technology that adapts to my level of learning

...National Curriculum based content to support what I'm learning at school

4-10 years



To learn more about this and other VTech® products, visit www.vtech.co.uk

INTRODUCTION

Thank you for purchasing the **Play & Dream Kicking Piano** by **VTech**®. This soft musical keyboard features five little friends and can be used in or out of the cot. Kick or tap the five piano keys to learn about animals and instruments and hear playful sing-along songs. In music mode, long playing melodies.

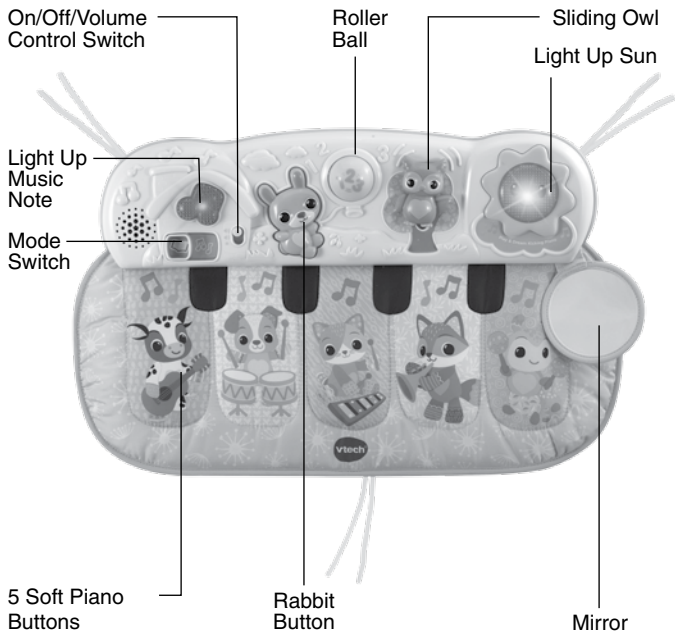

INCLUDED IN THIS PACKAGE

- Play & Dream Kicking Piano
- Quick Start Guide

WARNING

All packing materials such as tape, plastic sheets, packaging locks, removable tags, cable ties, cords and packaging screws are not part of this toy and should be discarded for your child's safety.

NOTE

Please save this Instruction Manual as it contains important information.

WARNING

Please remove the piano from the cot when the child is sleeping.

WARNING

All packing materials such as tape, plastic sheets, packaging locks, removable tags, cable ties, cords and packaging screws are not part of this toy, and should be discarded for your child's safety.

Unlock the Packaging Locks:

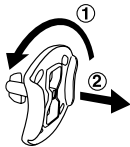

① Rotate the packing locks
90 degrees anticlockwise

② Pull out the packing locks

GETTING STARTED

Battery Removal and Installation

1. Make sure the unit is turned **OFF**.
2. Locate the battery cover on the back of the unit. Use a screwdriver to loosen the screw and then open the battery cover.
3. If used batteries are present, remove these batteries from the unit by pulling up on one end of each battery.
3. Install 2 new AA (AM-3/LR6) batteries following the diagram inside the battery box. (For best performance, alkaline batteries or fully charged Ni-MH rechargeable batteries are recommended).
5. Replace the battery cover and tighten the screw to secure.

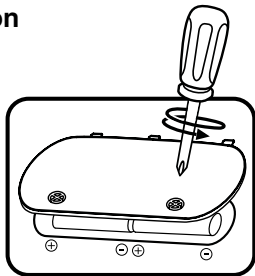

WARNING:

Adult assembly required for battery installation. Keep batteries out of reach of children.

IMPORTANT: BATTERY INFORMATION

- Insert batteries with the correct polarity (+ and -).
- Do not mix old and new batteries.
- Do not mix alkaline, standard (carbon-zinc) or rechargeable batteries.
- Only batteries of the same or equivalent type as recommended are to be used.
- Do not short-circuit the supply terminals.
- Remove batteries during long periods of non-use.
- Remove exhausted batteries from the toy.
- Dispose of batteries safely. Do not dispose of batteries in fire.

RECHARGEABLE BATTERIES:

- Remove rechargeable batteries from the toy before charging.
- Rechargeable batteries are only to be charged under adult supervision.
- Do not charge non-rechargeable batteries.

Disposal of batteries and product



The crossed-out wheellie bin symbols on products and batteries, or on their respective packaging, indicates they must not be disposed of in domestic waste as they contain substances that can be damaging to the environment and human health.



The chemical symbols Hg, Cd or Pb, where marked, indicate that the battery contains more than the specified value of mercury (Hg), cadmium (Cd) or lead (Pb) set out in the Batteries and Accumulators Regulation.

The solid bar indicates that the product was placed on the market after 13th August, 2005.

Please dispose of your product and batteries responsibly.

In the UK, give this toy a second life by disposing of it at a small electricals collection point* so all of its materials can be recycled.

Learn more at:

www.vtech.co.uk/recycle

www.vtech.com.au/sustainability

* Visit www.recyclenow.com to see a list of collection points near you.

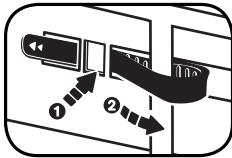
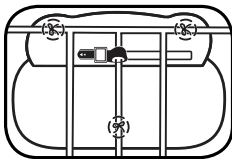
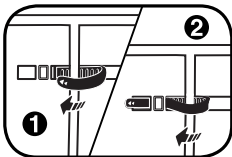
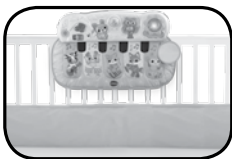

ASSEMBLY INSTRUCTIONS

1. Place the unit inside the cot.
2. Loop the cot attachment strap around the nearest spindle and slide it under the slot on the back of the unit, pulling to secure.
3. Once the cot attachment strap is securely fastened, please tie the three strings to the cot rail and the closest spindle. Pull slightly on the unit to make sure the strap and the three strings have been securely fastened. The unit should be snug against the cot rail. Please check the unit frequently to ensure it is still secure.
4. To remove the unit from the cot, untie the three strings, then hold down the square button near the cot attachment strap and pull the strap out of the slot.
5. When the unit is being used outside of the cot as a floor toy, please make sure the cot attachment strap is clipped into the back of the unit.



PRODUCT FEATURES

1. On/Off/Volume Control Switch

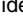
To turn the unit **On**, slide the **On/Off/Volume Control Switch** to the **Low Volume** () or **High Volume** () position. To turn the unit **Off**, slide the **On/Off/Volume Control Switch** to the **Off** () position.

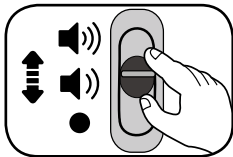

2. AUTOMATIC SHUT-OFF

To preserve battery life, the **VTech® Play & Dream Kicking Piano** will automatically power-down after approximately 39 seconds without input in the learning mode and 32 seconds without input in the music mode. The unit can be turned on again by pressing any button.

NOTE

If the unit repeatedly powers down during playing, please install a new set of batteries.

ACTIVITIES

1. Slide the **On/Off/Volume Control Switch** to turn the unit on. You will

hear a song, a phrase and a short tune. The lights will flash with the sounds.

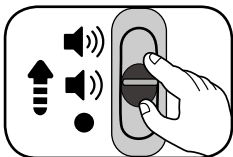

- ## 2. Press the **Piano Buttons** in learning mode to hear animal names, instrument names, instrument sounds and songs. In music mode you will hear piano notes, short tunes or animal sounds. The lights will flash with the sounds.

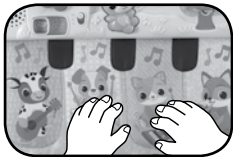

- Slide the **Owl** or press the **Rabbit** to hear fun sounds and playful phrases in learning mode. In music mode, you will hear music play for 15 minutes. While the melodies are playing, press the piano keys to hear fun sounds play over the melody. Press the roller ball to interrupt the melodies. The lights will flash with the sounds.
- Spin the **Roller Ball** in learning mode to hear fun sounds, counting phrases or a song. In music mode you will hear short tunes or fun sounds. The lights will flash with the sounds.



MELODY LIST

- Pat-A-Cake
- Row Your Boat
- Twinkle, Twinkle Little Star
- Brahms - Cradle Song
- Sugar Plum Fairy
- Bicycle Built For Two
- Did You Ever See a Lassie?
- Frère Jacques
- Little Bo Peep
- My Bonnie Lies Over The Ocean
- The Entertainer
- For He's a Jolly Good Fellow

13. Little Miss Muffet
14. Skip to My Lou
15. Oh Where Oh Where Has My Little Dog Gone
16. Yankee Doodle
17. Wagner - Ride of the Valkyries
18. Wheels on the Bus
19. Goosey Goosey Gander
20. Jack and Jill

SONG LIST

SONG 1

Friends and pals come gather round,
Sing and dance and laugh away.
Friends and pals let's make some sounds,
Have some fun and make some tunes - Hooray!

SONG 2

Cow plays guitar, strumming it to and fro.

SONG 3

Playful dog bangs on his drum,
Crash, boom, bash,
Crash, boom, bash,
Playful dog bangs on his drum,
Join him now.

SONG 4

Cute little cat, taps on the keys,
Plays her xylophone,
As we sing.

SONG 5

Little fox toots his trumpet with a blast,
Hear those melodies loud and fast!

SONG 6

Caterpillar rattles the maracas with a shake,
Shake shake without a break!

SONG 6

Let's play music now,
Let's play tunes together,
Tap, tap on the keys,
Music fun all day long!

CARE & MAINTENANCE

1. Keep the unit clean by wiping it with a slightly damp cloth.
2. Keep the unit out of direct sunlight and away from any direct heat source.
3. Remove the batteries when the unit will not be in use for an extended period of time.
4. Do not drop the unit on hard surfaces.

TROUBLESHOOTING

If for some reason the unit stops working or malfunctions, please follow these steps:

1. Please turn the unit **Off**.
2. Interrupt the power supply by removing the batteries.
3. Let the unit sit for a few minutes, then replace the batteries.
4. Turn the unit **On**. The unit should now be ready to play with again.
5. If the unit still does not work, install a new set of batteries.

CONSUMER SERVICES

Creating and developing **VTech**[®] products is accompanied by a responsibility that we at **VTech**[®] take very seriously. We make every effort to ensure the accuracy of the information, which forms the value of our products. However, errors sometimes can occur. It is important for you to know that we stand behind our products and encourage you to call our Consumer Services Department with any problems and/or suggestions that you might have. A service representative will be happy to help you.

UK Customers:

Phone: 0330 678 0149 (from UK) or +44 330 678 0149 (outside UK)
Website: www.vtech.co.uk/support

Australian Customers:

Phone: 1800 862 155
Website: support.vtech.com.au

NZ Customers:

Phone: 0800 400 785
Website: support.vtech.com.au

PRODUCT WARRANTY/ CONSUMER GUARANTEES

UK Customers:

Read our complete warranty policy online at vtech.co.uk/warranty.

Australian Customers:

VTECH ELECTRONICS (AUSTRALIA) PTY LIMITED –
CONSUMER GUARANTEES

Under the Australian Consumer Law, a number of consumer guarantees apply to goods and services supplied by VTech Electronics (Australia) Pty Limited. Please refer to vtech.com.au/consumerguarantees for further information.

**Visit our website for more
information about our products,
downloads, resources and more.**

www.vtech.co.uk
www.vtech.com.au

